

# OPERATING INSTRUCTIONS

e11 022771

## *Headrest 7.0" 16:9 Color Display Monitor*

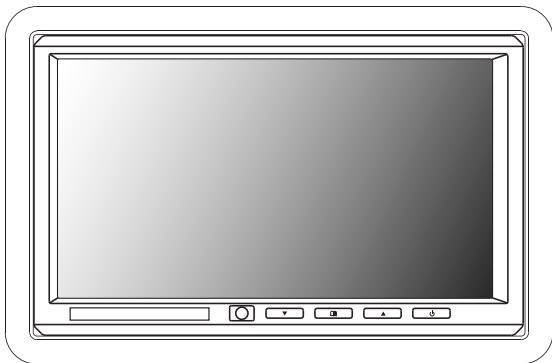

### Important Notice

It is unlawful in most jurisdictions for a person to drive a motor vehicle which is equipped with a television or screen that is located in the motor vehicle at any point forward of the back of the driver's seat, or that is visible directly or indirectly to the driver while operating the vehicle.

### CAUTION

1. Do not expose to direct sunlight for extended periods of time.
2. Do not drop the monitor or expose to strong impacts.
3. Keep the monitor clean and dry.
4. Do not operate the monitor at temperatures below 32°F (0°C) or above 140°F (60°C).

## Installation Guide:

The kit includes a protective trim ring and an optional spacer ring for use when the mounting surface is uneven.

1. Select appropriate locations in your vehicle for the monitor .
2. Be sure there is sufficient depth for the trim ring. Add the spacer ring for shallow locations with uneven curved surfaces such as upholstery. Be sure there is enough space for both the trim ring and for any excess interconnect cable.
3. Ensure that the interconnect cable will reach from the monitor location .
4. Create the required opening for the monitor and trim ring. Be sure it is not too large, and that there is enough space behind the trim ring to store any excess interconnect cable. Excess cable does not fit within the trim ring.
5. Route the cable through the opening in the trim ring
6. Connect the cable to the monitor.
7. Securely snap the monitor into place.

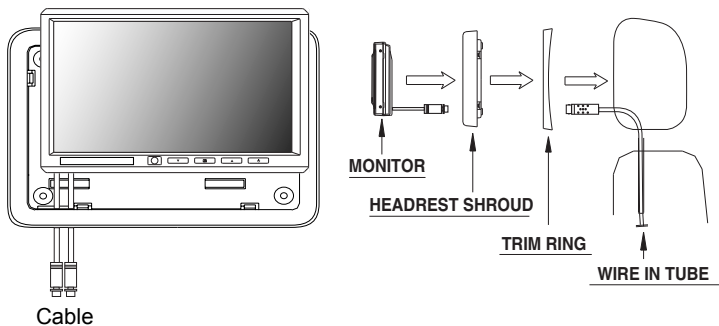

If you need to remove the monitor from the trim ring, insert a credit card between the monitor and the trim ring to release the monitor from the flexible locking retainer tabs. Gently pull the monitor from the trim ring. Very gentle pressure can be applied using the credit card.

## Electrical Connections:

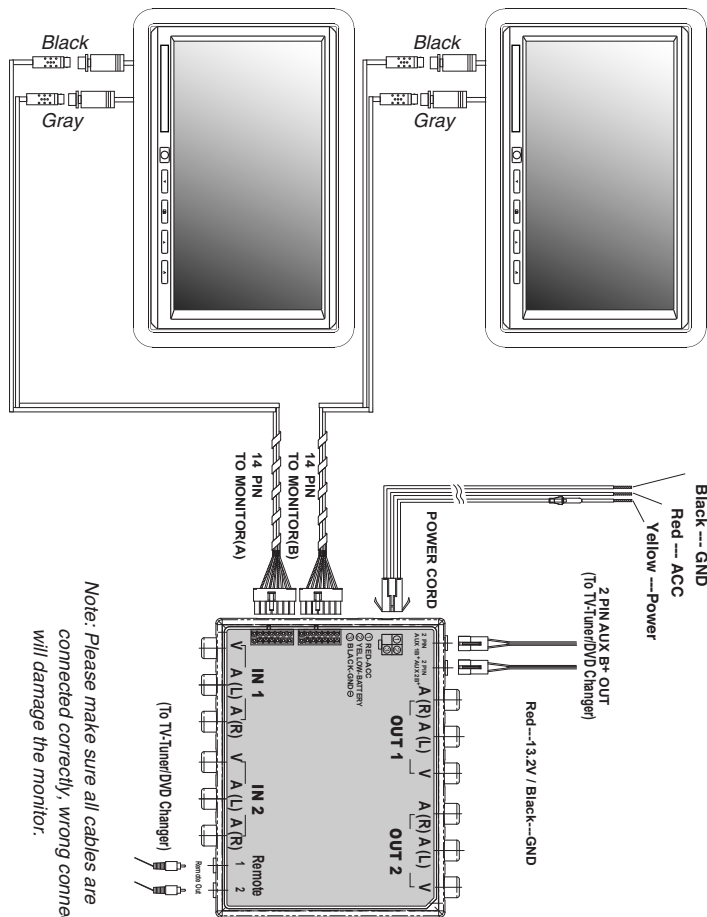

*Note: Please make sure all cables are connected correctly, wrong connections will damage the monitor.*

## Basic Operation:

### Front Control Panel:

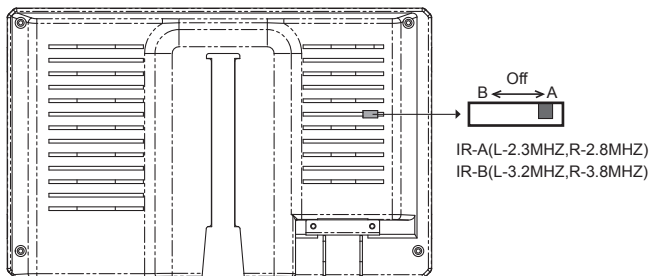
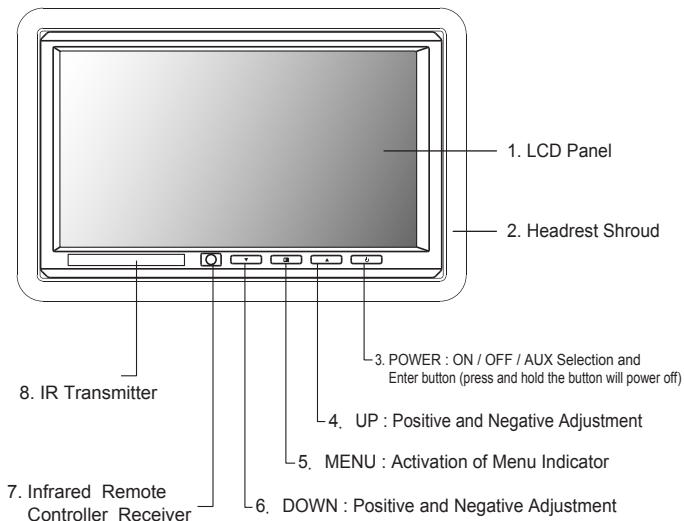

## REMOTE CONTROL:

---

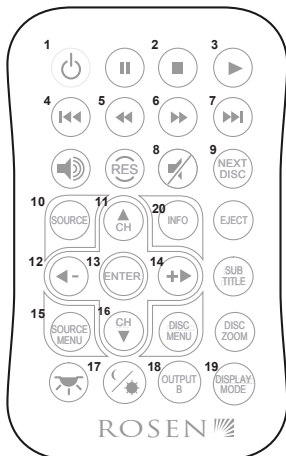

### USING THE REMOTE CONTROL

You can use the remote control to operate the system, including access to features not available on the front panel. For definitions of each remote control button's specific function, see the following pages.

- |    |  |    |  |
|----|--|----|--|
| 1  | Power On/Off (TV-TUNER / DVD Changer / Single disk DVD ) |    |  |
| 2  | Stop ( Ext DVD )   |    |  |
| 3  | Play / Pause ( Ext DVD )                                 |    |  |
| 4  | Previous Chapter/Track ( Ext DVD )                       |    |  |
| 5  | Reverse ( Ext DVD )                                      |    |  |
| 6  | Fast forward ( Ext DVD )                                 |    |  |
| 7  | Next Chapter/Track ( Ext DVD )                           |    |  |
| 8  | Mute (On / Off)  |    |  |
| 9  | Next Disc ( Ext DVD )                                    |    |  |
| 10 | Source select  |    |  |
| 11 | Navigate Up  |    |  |
|    |  | 12 | Navigate left                                |
|    |  | 13 | Enter  |
|    |  | 14 | Navigate Right                               |
|    |  | 15 | Source Setup Menu- Auto Tune (TV Tuner only) |
|    |  | 16 | Navigate Down                                |
|    |  | 17 | Dimmer (Day/Night Mode)                      |
|    |  | 18 | Output B Control (Tuner only)                |
|    |  | 19 | Display Mode                                 |
|    |  | 20 | INFO ( Ext DVD )                             |

*Note: If you try to perform a DVD action when it is not permitted (such as accessing the disc menu while the disc is loading), there will be no response from the unit. This is normal operation and is not a problem with your system.*

## BASIC REMOTE CONTROL BUTTONS:

---

### 1 TV-Tuner / DVD Changer (POWER)

Pressing this POWER (  ) button will turn the unit on. If unit off, a single press should turn the unit on. Otherwise once the unit is on, a single press should change source.

### 2 Stop

Press once to temporarily stop playback of a DVD. To resume normal playback from the same point, press **PLAY**.

To play the disc from the beginning, press **STOP** *twice*, then **PLAY**.

### 3 Play/Pause

Press to begin or resume playback of a DVD.

Press once to pause playback. Press repeatedly to advance video frame by frame. To resume normal playback, press **PLAY**.

*Note: When the disc is first inserted, you may have to press **PLAY** or **ENTER** to begin playback.*

### 4 Previous Chapter/Track

Press to jump to the previous title or chapter, if available on a DVD, or to the previous track on an audio CD. Not supported with some VCDs.

### 5 Reverse

Press to search in reverse. To resume normal playback, press **PLAY**.

## BASIC REMOTE CONTROL BUTTONS:

---

### 6 Forward/Search

Press during playback to fast forward. Press the **RIGHT** and **LEFT** arrow buttons to adjust search direction and speed. Choose from 2x, 4x, 6x, and 8x. Press **PLAY** to resume regular play.

### 7 Next Chapter/Track

Press to jump to the next title or chapter, if available on a DVD, or to the next track on an audio CD. Not supported with some VCDs.

### 8 Mute

Press once to mute all system audio. As long as the Mute function is active, "Mute" will appear on the screen. Press again to turn Mute off.

### 9 Next Disc

When the optional R5006 DVD Changer is connected, this button commands the changer to play the next disc in the magazine.

### 10 Source

This button lets you select the internal DVD/CD player, the Internal Game, or the Auxiliary input. You can also select the optional TV Tuner, DVD Changer, or other optional auxiliary sources, if installed.

### 11, 16 Navigate Up/Down Arrows

Press to move up or down in a menu or to change channel when watching TV.

## BASIC REMOTE CONTROL BUTTONS:

---

**12, 14 Left/Right Arrows**  

Press to move left or right in a menu.

**13 Enter** 

Press to make a menu selection.

**15 Source Menu** 

If the source unit selected has a Setup Menu, you can access it by pressing Source Menu. With the optional TV Tuner, this button activates the Auto-Program feature, which stores all available TV stations in the memory for easier, faster channel-changing.

**17 DIMMER (Day/Night Mode)** 

This button decreases display brightness for optimum viewing in low light conditions.

Set the Brightness level in daytime conditions with plenty of ambient light, and with the headlights off. Then you can use this button to switch between Day and Night modes.

**19 Display Mode** 

This button lets you select from the various screen display modes.

## INSTALL SETUP:

---

Press remote control "EJECT➔ENTER➔INFO➔ENTER" button on remote to setup system

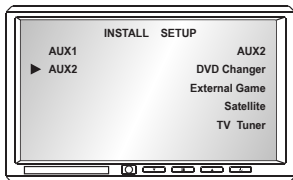
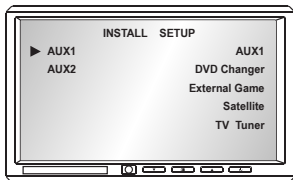

## BASIC REMOTE CONTROL BUTTONS:

---

### 20 INFO



Press to view the status, current title number, track number and the total playing time of the currently-playing disc.

## REPLACING THE REMOTE BATTERY

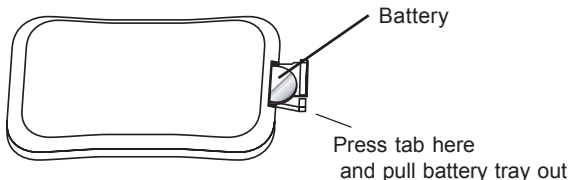

Use a single 3V battery, type CR2025. Insert as shown. Observe the correct orientation of the battery as marked on the battery tray.

Battery life is approximately six months, depending on how often the remote is used.

## On-Screen-Display Settings:

### MODE:

When monitor is power on, press mode button control panel to select video inputs AV1/AV2 NTSC/PAL. (Press and hold power button on control panel will power off the monitor.)

### MONITOR SETTINGS:

Press the Menu button control panel, the OSD menu will show the LCD screen as below, use the menu button on front control panel to select setting .

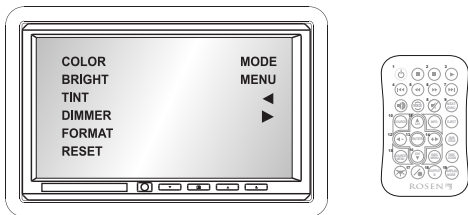

### COLOR:

Press Menu button control panel, OSD menu will show on LCD screen as below (left chart), press menu button control panel to select "COLOR" setting, "COLOR" setting will show as below (right chart).

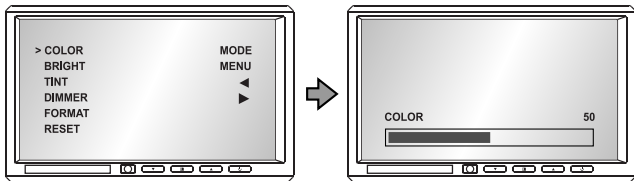

### BRIGHT:

Press Menu button on control panel, OSD menu will show on LCD screen as below (left chart), "BRIGHT" setting will show as below (right chart).

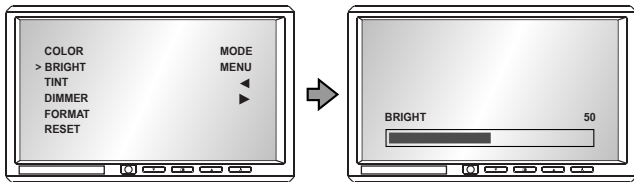

## On-Screen-Display Settings:

### TINT:

Press Menu button on control panel, OSD menu will show on LCD screen as below (left chart), and hold up/down button on control panel to select "TINT" setting. "TINT" setting will show as below (right chart).

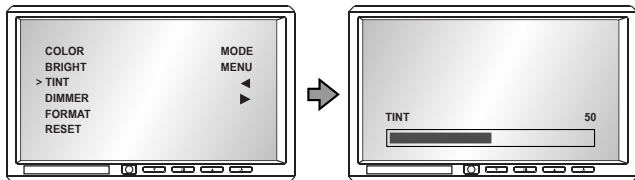

### DIMMER:

Press Menu button on remote or on control panel, OSD menu will show on LCD screen as below (left chart), press up/down button on remote or press and hold up/down button on control panel to select "DIMMER" setting. "DIMMER" setting will show as below (right chart).

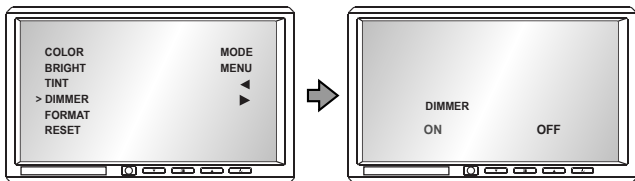

### DISPLAY MODE: (FORMAT)

Press Menu button on remote or on control panel, OSD menu will show on LCD screen as below (left chart), press up/down button on remote or up/down button on control panel to select "FORMAT" setting, Press enter button on or power button on control panel to select "FORMAT" setting, NORMAL/ PANORAMA/ ZOOM/ FULL display mode. "FORMAT" setting will show as below (right chart).

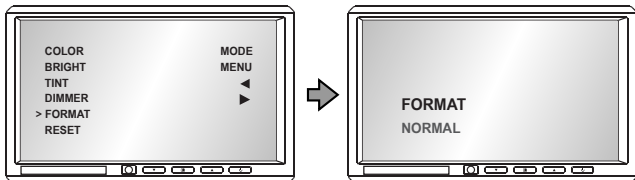

## On-Screen-Display Settings:

---

### RESET IMAGE:

Press Menu button on control panel, OSD menu will show on LCD screen as below (left chart), press up/down button on control panel to select "RESET" setting. Press enter button on power button on control panel to select "RESET" setting, "RESET" setting will show as below (right chart).

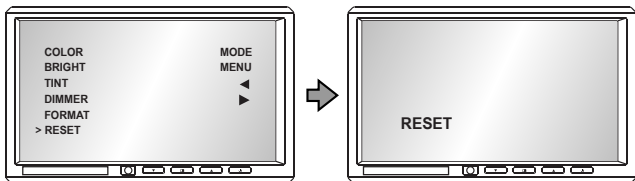

### Installation Notes:

---

The Wide Screen Universal Monitor includes mounting options described in the following sections. Before you install the monitor, consider the following important notices:

1. NEVER install this monitor where it can be viewed from the driving position; this is a violation of many state and local vehicle codes.
2. Avoid mounting locations where there is a risk of impact with a passenger in the event of an accident.
3. Always mount the monitor securely using the mounting hardware that is provided. Do not use the monitor unless it is properly secured to the vehicle.

### Box Contents:

The Widescreen Universal Monitor includes the following parts and equipment:

- |                                |                                |
|--------------------------------|--------------------------------|
| 1. Monitor x2                  | 7. Flush mounting trim ring x2 |
| 2. Remote Control x1           | 8. Headrest shroud x2          |
| 3. Power Cord (YEL/RED/BLK) x1 | 9. Manual x1                   |
| 4. Cable wire (BLK/GRY) x2     | 10. IR remote cable x2         |
| 5. Adaptor x1                  |                                |
| 6. AUX B+ Out wire x2          |                                |